



SERIES CHS 2 TS

TRANSLATING SCREW

SERIES CHS 2 TS - 1000 daN · TPN 20x4

| SCREW JACK MODEL | | CHS 2 |
|--------------------------------|--|-------------------------|
| LOAD | daN (Kg) | 1000 |
| TPN SCREW | DIAMETER mm PITCH mm | 20 4 |
| GEAR RATIOS | FAST SPEED NORMAL SPEED SLOW SPEED | 5:1 10:1 30:1 |
| STROKE FOR INPUT REV. | FAST SPEED NORMAL SPEED SLOW SPEED | 0,80 0,40 0,13 |
| EFFICIENCY | FAST SPEED NORMAL SPEED SLOW SPEED | 24,8% 23,1% 21,5% |
| JACK WEIGHT (Kg) | | 4,0 |
| SCREW WEIGHT TPN X 100 mm (Kg) | | 0,20 |
| CASE MATERIAL | | G25 |
| GREASE QTY (Kg) | | 0,1 |
| GREASE TYPE | AGIP GR MU EP2 | |
| OPERATING TEMPERATURE | -5° C +80° C | |

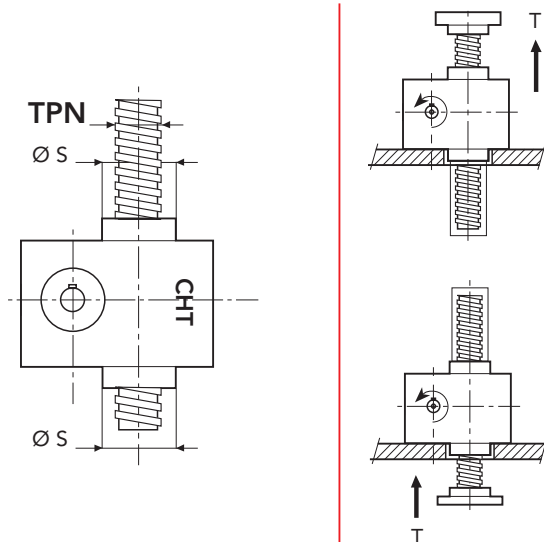
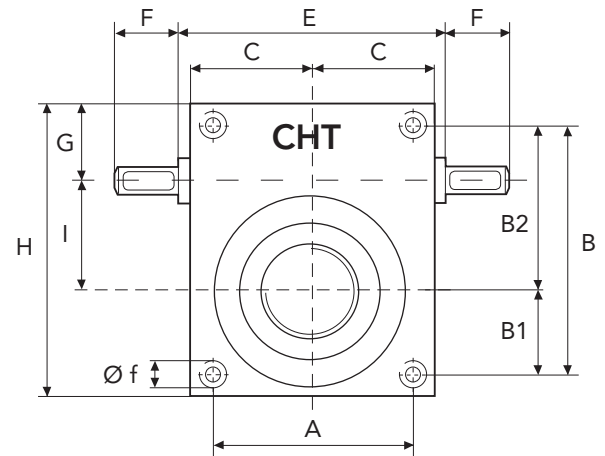
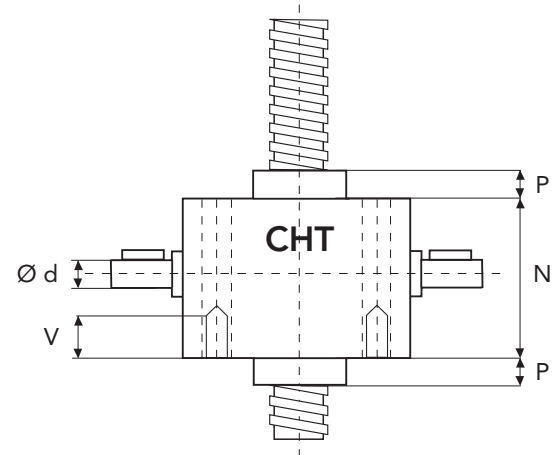

| | A | B | B1 | B2 | C | E | F | G | H |
|------|----|----|----|----|----|-----|------|------|------|
| CHS2 | 80 | 85 | 30 | 55 | 49 | - | 23,5 | 33,5 | 102 |
| | I | N | P | P1 | V | Ø d | Ø f | Ø s | TPN |
| CHS2 | 30 | 70 | 20 | 15 | * | 12 | 8,4 | 44 | 20x4 |

* tapped holes on request

